

## **PANASONIC DVC-20**

1. **VTR Controls:** Controls playback of video in VTR mode
2. **Microphone:** Stereo / using input jack limits audio to left track  
Mic. cable and omni or uni mic. must be used.
3. **Lens:** Manual focus ring & zoom control. To focus: zoom in,  
adjust focus, pull back out. Always replace lens cap
4. **Speaker & Headphones:** On left side / headphone jack on lower right side  
(uses mini 1/8" stereo plug)
5. **Eyepiece & LCD:** Adjustment diopter for vision. Use LCD screen for  
composition & framing.
6. **Tripod plate:** Always use a tripod
7. **Multi-Function VTR controls:** Controls camera settings, shutter speed, iris & WB  
In conjunction with menu button (center but. = Enter)
8. **Auto / Man. Mode:** Auto / Manual / Focus
9. **White Balance:** (In different light conditions) indoor / outdoor temps.  
Set switch to Manual, Press [down but.] until AWB  
appears. Use [L/R but.] to select manual mode icon. Zoom  
full into white card, press [up but.] until icon stops flashing.  
(see below for details). Always use proper lighting.
10. **Battery Comp:** Battery release button / AC power connection
11. **Start / Stop:** Push to record / stop / Power: ON /OFF
12. **Mode switch:** VTR playback or Camera record mode
13. **Cassette Comp:** Eject button / Push to close CAREFULLY
14. **MENU SETTINGS:**
  - REC DATA > ON
  - TIMECODE > HRS:MINS:SECS:FRAMES
  - SET UP > DISPLAY > ON
  - SHUTTER SPEED RANGE > 1/60 - 1/8000
  - IRIS > F16 [CLOSED] F1.7 [OPEN] to +18dB
  - AUDIO VOLUME > use W/T controls [PLAYBACK]
  - BASIC > REC SPEED > SP
  - ADVANCE > MIC LEVEL > AUTO >16 bit - 48K
  - ADVANCE > CINEMA > [ON]
  - POWER SAVE > OFF
15. **STAY AWAY FROM:** WATER - MAGNETIC FIELDS - DUST
16. **DO NOT:** DROP, LEAVE UNATTENDED OR LEND TO  
A FRIEND - YOU BREAK YOU BUY!

**CSU cameras and other A/V equipment used in COM 204 projects cannot be reserved overnight or over weekends.**

## DVC-20 Operation:

### INSTALLING THE BATTERY:

Insert the battery on the right side of the camera. Insert the battery at the top of the slot with the arrow facing downward. Gently slide the battery until it locks into place.

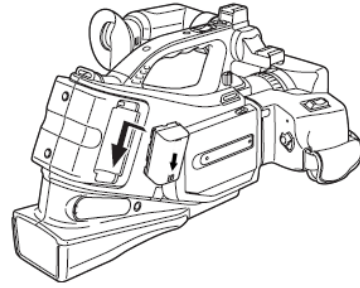

### TURNING THE CAMERA ON & OFF:

Power the camera by sliding the Power Switch located on the back of the zoom module to the ON position. Slide to OFF after removing tape.

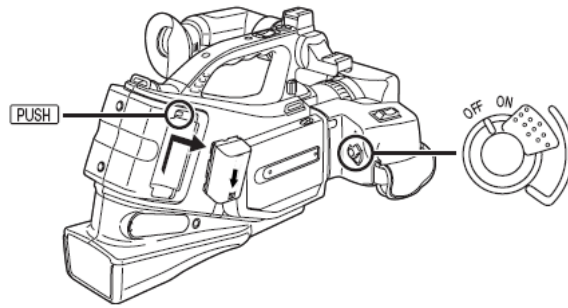

### REMOVING THE BATTERY:

Push the release button above the battery, slide up and out.

### CAMERA & VCR MODES:

Camcorder must be in CAMERA mode to record and VCR mode for playback.

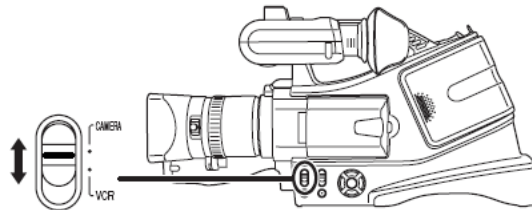

### INSERT TAPE:

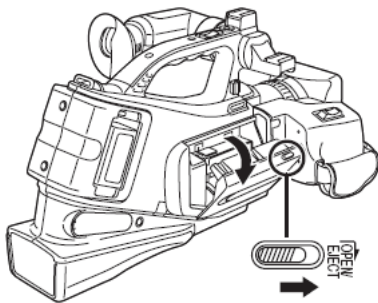

1. Slide Cassette Eject lever forward to open cassette compartment cover.

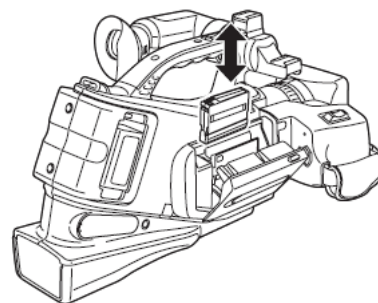

2. Insert cassette into metal cassette holder.

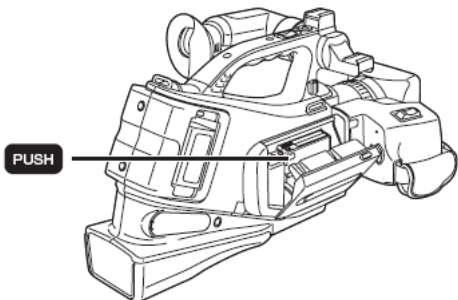

3. Press the PUSH mark to close the metal cassette holder. AFTER the cassette holder is completely housed, close the cassette compartment cover.

**CURSOR BUTTONS:**  
(UP, DOWN, LEFT, RIGHT, ENTER)



In **AUTO** Mode:

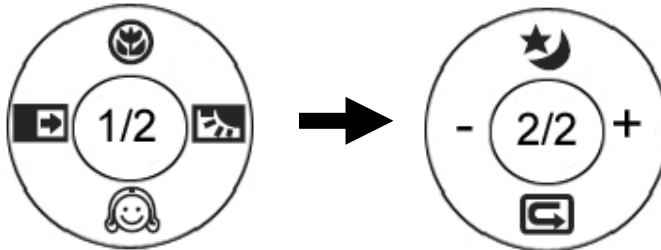

Press ENTER to display (1/2); select UP (Tele-Macro), DOWN (Soft Skin mode), LEFT (Fade) or RIGHT (Backlight Compensation).

Press ENTER again to display (2/2); select UP (Night View/0 Lux Night View) or DOWN (Recording Check).

Press ENTER again to lose display.

In **MANUAL** Mode:



Press ENTER to display (1/3); select UP (Tele-Macro), DOWN (Soft Skin) LEFT (Fade) or RIGHT (Backlight Compensation).

Press ENTER again to display (2/3); select UP (Night View/0 Lux Night View) or DOWN (Recording Check).

Press ENTER again to display (3/3); select DOWN (to cycle through White Balance, Shutter Speed, & Iris/Gain adjustments); LEFT (-, decrease) or RIGHT (+, increase).

Press ENTER again to lose display.

**TO MANUALLY WHITE BALANCE:**

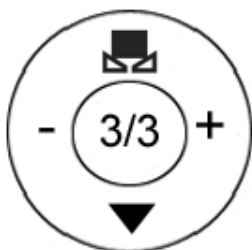

With “3/3” selected, display the  icon on the viewfinder by pressing the (+) key repeatedly. Hold a sheet of white paper in front of the camera lens so that it fills the screen, trying to reflect as much ambient light as possible from the room onto the white sheet or fasten the white cap over the lens and point it towards the light source. Press and hold the up (↑) button to activate the white balance process.

## MODE ICONS:



**Tele-Macro** sets lens for macro



**Soft Skin mode** softens detail of skin color



**Fade** allows Fade In and Fade out of picture and sound from/to Record Pause



**Backlight Compensation** better exposure for backlit subject



**Night View / 0 Lux Night View** low-light/no-light shooting



**Recording Check** views last 2-3 secs. of recorded shot.



**Automatic White Balance** adjust white balance automatically



**Indoor lighting – 3200K** select for incandescent lights



**Outdoor lighting – 5600K** select for sunlight



**Manual White Balance** select Manual White Balance, fill screen with white, press UP to black/white balance

## Monitor Displays:



White Balance setting

1/60

Shutter Speed setting

F2.0

Iris setting

0dB

Video Gain setting

**SP** Standard Record Speed



Widescreen mode



Battery Reserve



Manual Focus

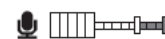

Audio Level